

Refrigerated Compressed Air Dryers

HITN SERIES - HIGH INLET TEMPERATURE



HITN HIGH INLET TEMPERATURE REFRIGERATED AIR DRYERS



MAKE THE RIGHT CHOICE

Hankison HITN High Inlet Temperature refrigerated air dryers are designed to efficiently dry compressed air with inlet temperatures up to 180°F.

With six pre-engineered sizes to choose from, the HITN is the ideal drying solution for auto service centers and general shop air applications that use piston type air compressors 5.0 to 30 horsepower.

BUILT TO INTERNATIONAL STANDARDS FOR PERFORMANCE, SAFETY & ENVIRONMENTAL SUSTAINABILITY

- ✓ Moisture removal to ISO 8573-1: 2010 Quality Class 6 (50°F) pressure dew point
- ✓ Certified for quality and safety to UL1995/CSA 22.2 No. 236-95
- ✓ Environmentally friendly R-134a and R-407c refrigerants

BUILT TO LAST

Stainless steel brazed plate heat exchangers with integral demister separator ensure optimal heat transfer for the life of the dryer

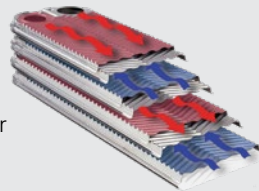

Adjustable timed electric drain – valve open and closed time – reliably discharges condensate from the dryer



Widely spaced Inlet/Outlet connections, flow direction stamped into cabinet, for ease of installation and filter mount

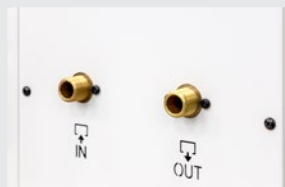

Instrumentation with lighted compressor On/Off switch, dew point temperature indicator and fault light



BETTER BY DESIGN

- Top mount fan, upward condenser air flow allows installation in tight spaces
- Bottom base rail with pre-drilled mounting holes for secure floor mount
- Quick release front panel for ease of access to dryer internals for routine maintenance



PROTECT YOUR SYSTEM WITH ISO QUALITY CLASS AIR

Dry the air then select a General Purpose filter to capture particles down to 1.0 micron and Coalescing filter to remove 99.9% of the oil.

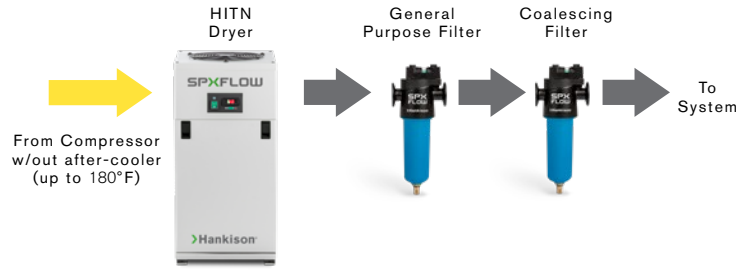

MODEL	CONNECTION (NPT)	ISO QUALITY CLASS MOISTURE	GENERAL PURPOSE AFTER-FILTER	CONNECTION (NPT)	ISO QUALITY CLASS SOLIDS	OIL REMOVAL AFTER-FILTER	CONNECTION (NPT)	ISO QUALITY CLASS OIL
HITN20 - HITN35	3/4"	6	F06-PF-DP1	3/4"	2	F06-HF-DP1	3/4"	1
HITN50 - HITN125	1"	6	F08-PF-DP1	1"	2	F08-HF-DP1	1"	1

After-Filters have Maximum Operating Temperature of 150°F.
Install downstream of dryer unless the inlet air temperature is ≤ 150°F.

HITN SERIES PRODUCT SPECIFICATIONS

MODEL	FLOW CAPACITY SCFM ¹	POWER REQUIREMENTS		IN / OUT CONNECTIONS NPT	REFRIGERANT COMPRESSOR CAPACITY BTU/hr	REFRIGERANT TYPE ²	MAXIMUM WORKING PRESSURE ³ PSIG / BAR	MAXIMUM INLET TEMPERATURE ³ °F / °C	AMBIENT TEMPERATURE RANGE ³ °F / °C
		V/ph/Hz	kW						
HITN20	20	115/1/60	0.69	3/4"	4982	R-134a	42-227 psig 3.0-16.0 bar	40°F-180°F 4°C-82°C	40°F-110°F 4°C-43°C
HITN25	25	115/1/60	0.69	3/4"	4982	R-134a			
HITN35	35	115/1/60	0.99	3/4"	9724	R-407c			
HITN50	50	115/1/60	0.83	1"	12420	R-407c			
HITN75	75	115/1/60	1.13	1"	12420	R-407c			
HITN125	125	230/1/60	1.97	1"	19300	R-407c			

- Rating conditions are 180°F inlet temperature, 125 psig inlet pressure, 100% inlet relative humidity, 100°F ambient temperature.
- Refer to dryer data plate for refrigerant charge.
- To ensure optimal performance, do not operate continuously in conditions below or above max/min specifications.

MODEL	DIMENSIONS						WEIGHT	
	H		W		D		LBS	KG
	IN	MM	IN	MM	IN	MM		
HITN20	29	744	14	366	17	430	100	45
HITN25	29	744	14	366	17	430	100	45
HITN35	29	744	14	366	17	430	106	48
HITN50	41	1044	18	447	17	430	125	57
HITN75	41	1044	18	447	17	430	130	59
HITN125	46	1166	18	447	17	430	153	69



Global locations

SPX FLOW USA

4647 SW 40th Avenue
 Ocala, Florida 34474-5788 U.S.A.
 P: (724) 745-1555
 F: (724) 745-6040
 E: hankison.americas@spxflow.com

HANKISON RENTAL NORTHEAST

100 Commerce Drive, Suite 40
 Washington, PA 15301
 P: (724) 225-1470
 F: (724) 222-1317
 E: hankison.rental@spxflow.com

HANKISON RENTAL SOUTHWEST

8002 Breen Drive
 Houston, TX 77064 U.S.A.
 P: (800) 379-3711
 E: hankison.rental@spxflow.com

SPX FLOW SOUTH AMERICA

Rua Joao Daprat, 231 b
 09600-010-SÃO Bernardo
 Do Campo, SP
 Brazil
 T: +55 (11) 2166-4050
 F: +55 (11) 2166-4070

SPX FLOW GERMANY

Konrad-Zuse-Str. 25
 D-47445 Moers Germany
 T: (+49) 2841-8190
 F: (+49) 2841-87112
 E: info@spxdehydration.de

SPX FLOW INDIA

SPX India PVT, LTD
 Manufacturing G-72/73
 Riico Industrial Area
 Mansarovar, RAJASTHAN
 Jaipur 302 020
 India
 T: (+91) 141-2396759
 F:(+91) 141-2395048

SPX FLOW ASIA PACIFIC

5th Floor, Park Center,
 No.1568 Huashan Road,
 Shanghai China
 T: +86 (021) 2208-5840
 F: +86 (021) 2208-5866

SPX FLOW KOREA

#87, Jangansandan 9-ro,
 Jangan-eup, Gijang-gun,
 Busan, Rep. of Korea
 T: +82 (51) 728-5360
 F: +82 (51) 728-5359

SPX FLOW

4647 SW 40th Avenue
 Ocala, Florida 34474-5788 U.S.A.
 P: (724) 745-1555
 F: (724) 745-6040
 E: hankison.americas@spxflow.com
www.spxflow.com/hankison

SPX FLOW, Inc. reserves the right to incorporate our latest design and material changes without notice or obligation.

Design features, materials of construction and dimensional data, as described in this bulletin, are provided for your information only and should not be relied upon unless confirmed in writing. Please contact your local sales representative for product availability in your region. For more information visit www.spxflow.com.

The green "S" and "X" are trademarks of SPX FLOW, Inc.